

LOCUS MAP  
1" = 2,000'±

LEGEND	
	EXISTING LIDAR CONTOURS
	EDGE OF BORDERING VEGETATED WETLANDS
	EX-UTILITY POLE
	OVERHEAD UTILITIES
	EX. STONE REVETMENT
	TOP OF BANK
	BOTTOM OF BANK
	EX. COBBLES/STONES
	EX. GATE
	MEAN HIGH WATER (OBSERVED 1/10/2013)
	EDGE OF POND
	EOP
	NHESP PRIORITY HABITATS OF RARE SPECIES

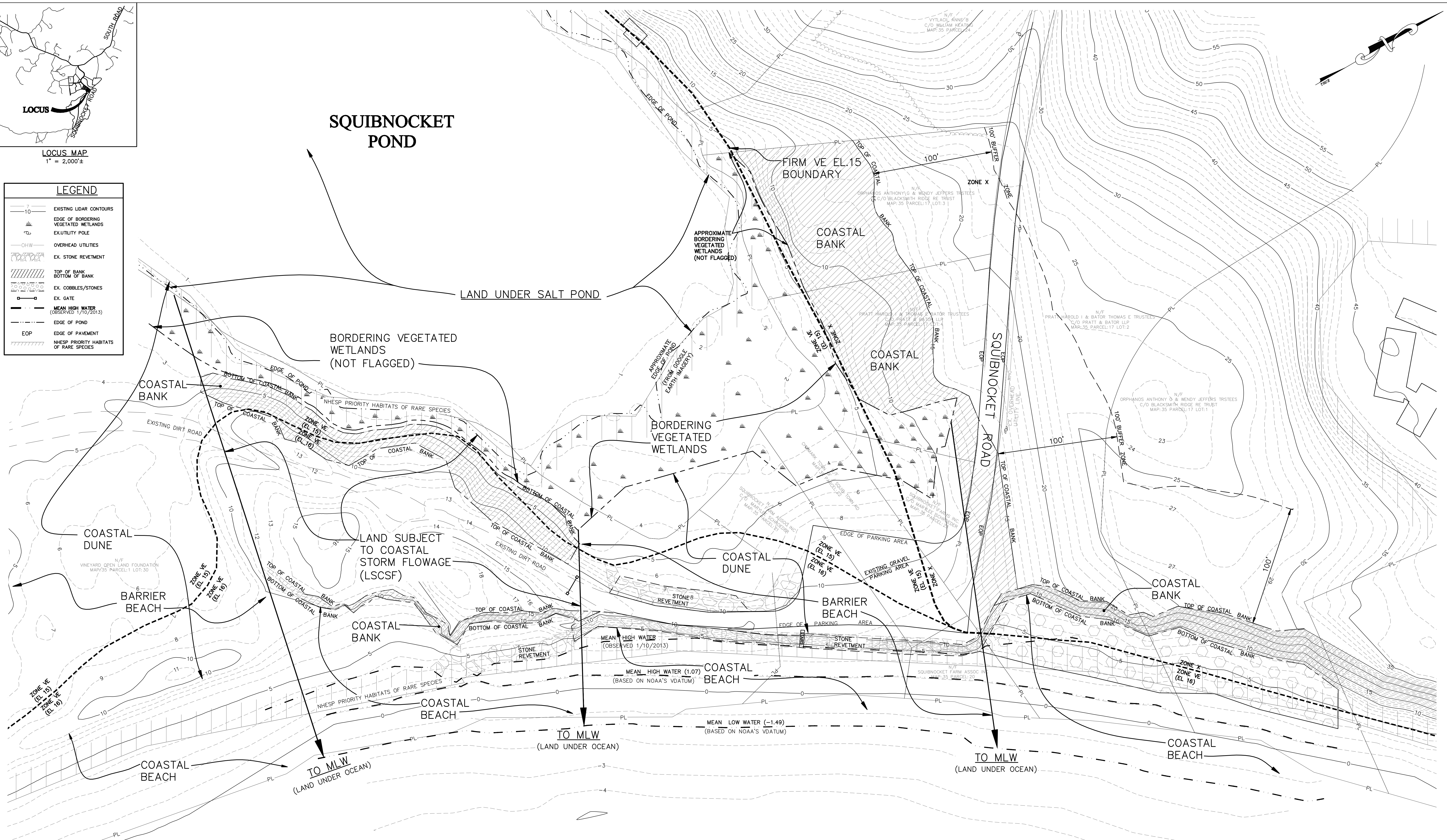

- GENERAL NOTES:**
1. THE AREA LIES WITHIN ZONING DISTRICT NO. VI BASED UPON A REVIEW OF THE TOWN OF CHILMARK ZONING MAP AND WITHIN THE SQUIBNOCKET POND OVERLAY DISTRICT.
  2. THE PROPERTY LINES DEPICTED HEREON ARE BASED UPON THE MASSACHUSETTS GEOGRAPHIC INFORMATION SYSTEM AND ARE FOR INFORMATIONAL PURPOSES ONLY.
  3. FLOOD ZONE BOUNDARIES SHOWN HEREON ARE, BASED UPON A REVIEW OF THE FEDERAL EMERGENCY MANAGEMENT AGENCY (FEMA) FLOOD INSURANCE RATE MAP (FIRM) COMMUNITY PANEL NUMBER 25007C0159J, PRELIMINARY DATE: JUN 3, 2013.
  4. THE AREA DOES NOT LIE WITHIN A ZONE II WELLHEAD PROTECTION AREA BASED UPON A REVIEW OF THE MASSACHUSETTS GEOGRAPHIC INFORMATION SYSTEM.
  5. THE AREA DOES NOT LIE WITHIN AN AREA OF CRITICAL ENVIRONMENTAL CONCERN BASED UPON A REVIEW OF THE MASSACHUSETTS GEOGRAPHIC INFORMATION SYSTEM.
  6. THE AREA LIES WITHIN AN ESTIMATED HABITAT OF RARE WILDLIFE OR A PRIORITY HABITAT OF RARE SPECIES BASED UPON A REVIEW OF THE NATURAL HERITAGE AND ENDANGERED SPECIES PROGRAM MAPS OBSERVED ON THE MASSACHUSETTS GEOGRAPHIC INFORMATION SYSTEM.
  7. THE EXISTING CONDITIONS SHOWN HEREON ARE COMPILED FROM SURVEY WORKSHEET AND PLAN PROVIDED BY THE CLIENT INCLUDING A PLAN ENTITLED "SITE PLAN FOR SQUIBNOCKET PARKING LOT COMMITTEE" DATED JUNE 11, 2013 BY VINEYARD LAND SURVEYING & ENGINEERING, INC., 12 COUMOYER ROAD, P.O. BOX 421, WEST TISBURY, MA. AND ARE NOT THE RESULT OF A FIELD SURVEY BY ATLANTIC DESIGN ENGINEERS, INC.
  8. THE EXISTING TOPOGRAPHY SHOWN HEREON IS BASED UPON 2010 LIDAR CONTOUR DATA (NAVD98) OBTAINED FROM THE MASSACHUSETTS GEOGRAPHIC INFORMATION SYSTEM AND SUPPLEMENTED BY A FIELD SURVEY BY ATLANTIC DESIGN ENGINEERS, INC. IN JULY 2013.
  9. WETLANDS RESOURCE AREAS SHOWN AS PROVIDED BY LEC ENVIRONMENTAL CONSULTANTS, INC.

ATLANTIC OCEAN

NHESP PRIORITY HABITATS OF RARE SPECIES

WETLANDS RESOURCE MAP  
FOR  
SQUIBNOCKET POND PROJECT  
CHILMARK, MASSACHUSETTS  
AUGUST 13, 2014

PREPARED FOR:  
**FRIENDS OF SQUIBNOCKET**  
C/O TONY ORPHANOS, 61 CROSBY STREET  
NEW YORK, NY 10012

**Atlantic** DESIGN ENGINEERS, L.L.C.  
P.O. Box 1051, Sandwich, MA 02563 (508) 888 - 9282

Designed by :	SCALE	Sheet of
Drawn by :	SCALE 1" = 30'	2 2
Checked by :		JOB NUMBER
Survey chk. by :	DATE	2772.01
Approved by :	NO.	BY
	DATE	REVISION